



LONGFIELD HALL

SHOWCASING OUR HISTORY: LONGFIELD HALL

# THE ARRIVAL OF THE MINET ESTATE

*A Most Strangely Beautiful Place* Sir John Betjeman

## Brixton Fruit Social.

The Brixton branch of the Unionist Labour League on Wednesday night held a most successful "social" at the Longfield Hall, Myatt's Park, where upwards of 250 ladies, visitors, and members of the branch thoroughly enjoyed this experimental entertainment under the presidency of the chairman of the branch, Councillor H. Baldwin, who was ably supported by Mr. A. J. Hutson, the indefatigable secretary, and a willing band of a dozen stewards. Twenty-seven musical "turns" and recitations were very enthusiastically received, interspersed by a gratuitous distribution of luscious strawberries, grapes, cherries, &c., during the interval.

Although encores were not allowed, they were demanded in the cases of Mr. Will Carry and Mr. Good, "lion" comics. Miss Miller gave a fine rendering of the very popular "Land of Hope and Glory," and Miss Maud Crow sang "Tatters" delightfully.

The chairman announced that another "social," or garden party, will be held about three weeks hence.

South London Press  
7 July 1906

Longfield Hall and the Minet Library played a significant role in the area's steady transition from a place of ill repute to a desirable location for middle-class families.

Improved railways and transport brought more people to live in the area. The hall and library were designed by George Hubbard, twice president of the Royal Institute of British Architects. The library

was originally designed to be a hall for St James' church. When William Minet's first wife Alice died in 1887 before the building was completed he decided to turn it into a public library in her memory.



Longfield Hall & Minet Library  
1890

Plan of the Minet Library building  
1887.

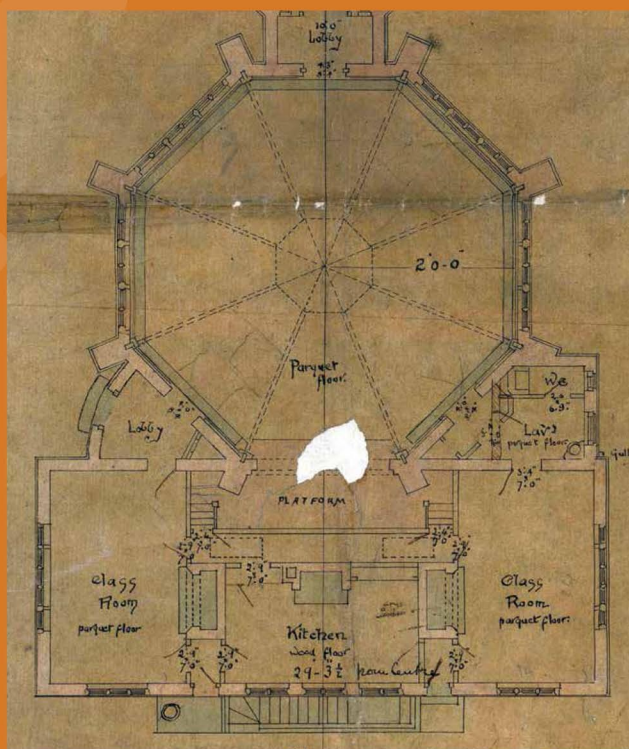

As well as serving as a church hall for St James', a broad spectrum of functions and receptions were held in Longfield Hall ranging from the St James' Choral Society, concerts, annual reunions of the Lyndhurst Old Boys Association, Loughborough Junction's Co-operative Society, 'fruit socials' and the annual Christmas concert given by pupils of the Misses Norris's preparatory day school at 70 Burton Road.

Images courtesy of Lambeth Archives